

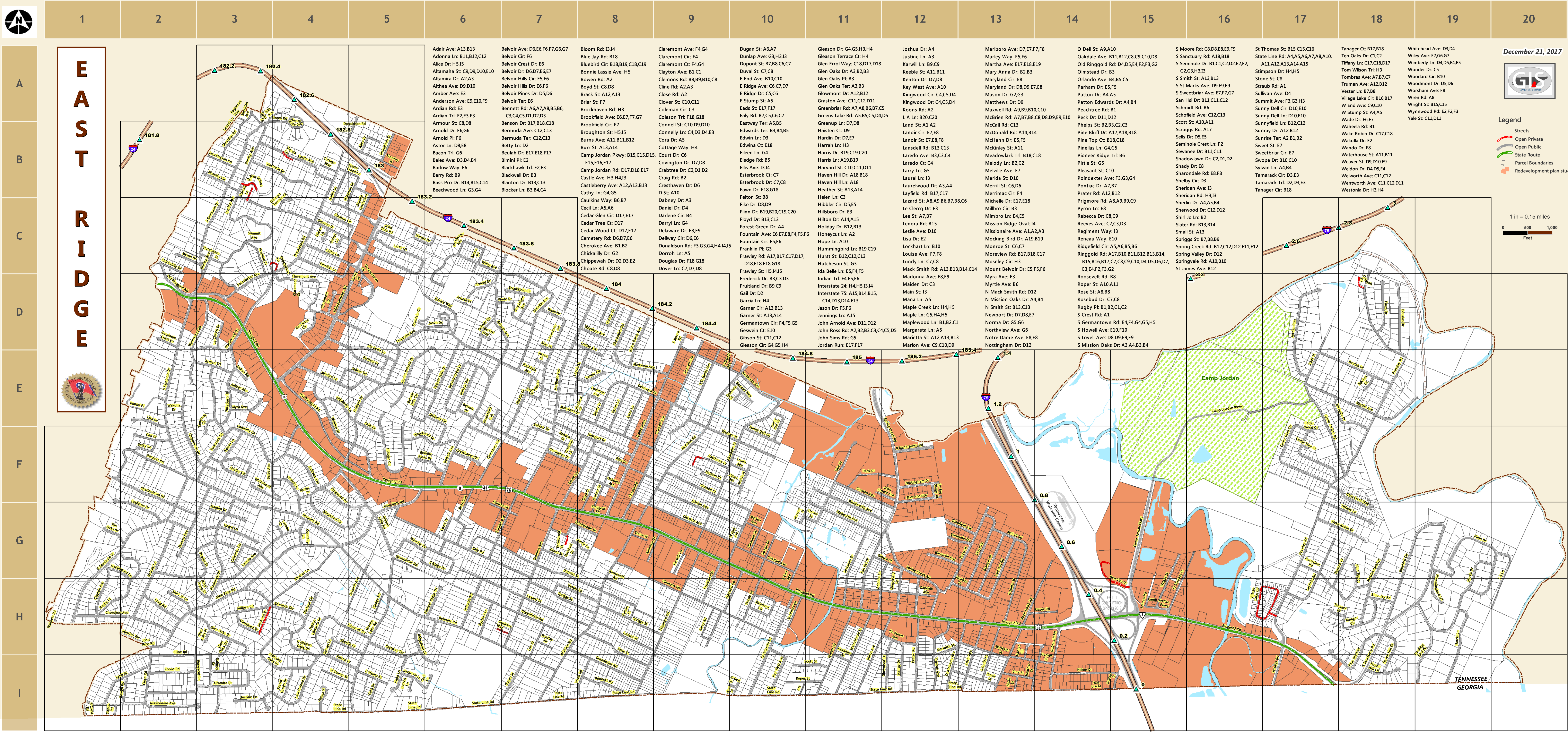

EAST RIDGE



- Adair Ave: A13,B13
- Adonna Ln: B11,B12,C12
- Alice Dr: H5,I5
- Altamaha St: C9,D9,D10,E10
- Altamira Dr: A2,A3
- Althea Ave: D9,D10
- Amber Ave: E3
- Anderson Ave: E9,E10,F9
- Ardian Rd: E3
- Ardian Trl: E2,E3,F3
- Arnold Dr: F6,G6
- Arnold Pl: F6
- Astor Ln: D8,E8
- Bacon Trl: G6
- Bales Ave: D3,D4,E4
- Barlow Way: F6
- Barry Rd: B9
- Bass Pro Dr: B14,B15,C14
- Beewood Ln: G3,G4
- Belvoir Ave: D6,E6,F6,F7,G6,G7
- Belvoir Cir: F6
- Belvoir Crest Dr: E6
- Belvoir Dr: D6,D7,E6,E7
- Belvoir Hills Cir: E5,E6
- Belvoir Hills Dr: E6,F6
- Belvoir Pines Dr: D5,D6
- Belvoir Trl: E6
- Bennett Rd: A6,A7,A8,B5,B6,C3,C4,C5,D1,D2,D3
- Benson Dr: B17,B18,C18
- Bermuda Ave: C12,C13
- Bermuda Trl: C12,C13
- Betty Ln: D2
- Beulah Dr: E17,E18,F17
- Bimini Pl: E2
- Blackhawk Trl: F2,F3
- Blackwell Dr: B3
- Blanton Dr: B13,C13
- Bloker Ln: B3,B4,C4
- Bloom Rd: I3,I4
- Blue Jay Rd: B18
- Bluebird Cir: B18,B19,C18,C19
- Bonnie Lassie Ave: H5
- Bowen Rd: A2
- Boyd St: C8,D8
- Brack St: A12,A13
- Briar St: F7
- Brookhaven Rd: H3
- Brookfield Ave: E6,E7,F7,F7
- Brookfield Cir: F7
- Brookfield Dr: H5
- Burns Ave: A11,B11,B12
- Burr St: A13,A14
- Camp Jordan Pkwy: B15,C15,D15,E15,E16,E17
- Camp Jordan Dr: D17,D18,E17
- Castle Ave: H3,H4,I3
- Castleberry Ave: A12,A13,B13
- Cathy Ln: G4,G5
- Caulkins Way: B6,B7
- Cecil Ln: A5,A6
- Cedar Glen Cir: D17,E17
- Cedar Tree Ct: D17
- Cedar Wood Ct: D17,E17
- Cemetery Rd: D6,D7,E6
- Cherokee Ave: B1,B2
- Chickally Dr: G2
- Chippewah Dr: D2,D3,E2
- Choate Rd: C8,D8
- Claremont Ave: F4,G4
- Claremont Cir: F4
- Clayton Ave: B1,C1
- Clemons Rd: B8,B9,B10,C8
- Cline Rd: A2,A3
- Close Rd: A2
- Clover St: C10,C11
- Coleman Cir: C3
- Coleson Trl: F18,G18
- Connell St: C10,D9,D10
- Connelly Ln: C4,D3,D4,E3
- Cora Dr: A5
- Cottage Way: H4
- Court Dr: C6
- Covington Dr: D7,D8
- Crabtree Dr: C2,D1,D2
- Craig Rd: B2
- Cresthaven Dr: D6
- D St: A10
- Dabney Dr: A3
- Daniel Dr: D4
- Darlene Cir: B4
- Darryl Ln: G4
- Delaware Dr: E8,E9
- Delway Cir: D6,E6
- Donaldson Rd: F3,G3,G4,H4,I4,I5
- Dorroh Ln: A5
- Douglas Dr: F18,G18
- Dover Ln: C7,D7,D8
- Dugan St: A6,A7
- Dunlap Ave: G3,H3,I3
- Dupont St: B7,B8,C6,C7
- Duval St: C7,C8
- E End Ave: B10,C10
- E Ridge Ave: C6,C7,D7
- E Ridge Dr: C5,C6
- E Stump St: A9
- Eads St: E17,F17
- Ealy Rd: B7,C5,C6,C7
- Eastway Ter: A5,B5
- Edwards Ter: B3,B4,B5
- Edwin Ln: D3
- Edwina Ct: E18
- Eileen Ln: G4
- Elledge Rd: B5
- Ellis Ave: I3,I4
- Ellis Ave: C7
- Esterbrook Ct: C7,C8
- Fawn Dr: F18,G18
- Felton St: B8
- Fike Dr: D8,D9
- Finn Dr: B19,B20,C19,C20
- Floyd Dr: B13,C13
- Forest Green Dr: A4
- Fountain Ave: E6,E7,E8,F4,F5,F6
- Fountain Cir: F5,F6
- Franklin Pl: G3
- Frawley Rd: A17,B17,C17,D17,D18,E18,F18,G18
- Frawley St: H5,I4,I5
- Frederick Dr: B3,C3,D3
- Fruitland Dr: B9,C9
- Gail Dr: D2
- Garcia Ln: H4
- Garner Cir: A13,B13
- Garner St: A13,A14
- Germantown Cir: F4,F5,G5
- Geswein Ct: E10
- Gibson St: C11,C12
- Gleason Cir: G4,G5,H4
- Gleason Dr: G4,G5,H3,H4
- Gleason Terrace Ct: H4
- Glen Errol Way: C18,D17,D18
- Glen Oaks Dr: A3,B2,B3
- Glen Oaks Pl: B3
- Glen Oaks Ter: A3,B3
- Glowmont Dr: A12,B12
- Graston Ave: C11,C12,D11
- Greenbriar Rd: A7,A8,B6,B7,C5
- Greens Lake Rd: A5,B5,C5,D4,D5
- Greenup Ln: D7,D8
- Haisten Ct: D9
- Hardin Dr: D7,E7
- Harris Dr: B19,C19,C20
- Harris Ln: A19,B19
- Harvard St: C10,C11,D11
- Haven Hill Dr: A18,B18
- Haven Hill Ln: A18
- Heather St: A13,A14
- Helen Ln: C3
- Hibbler Cir: D5,E5
- Hillsboro Dr: E3
- Hilton Dr: A14,A15
- Holiday Dr: B12,B13
- Honeycut Ln: A2
- Hope Ln: A10
- Hummingbird Ln: B19,C19
- Hurst St: B12,C13
- Hutcheson St: G3
- Ida Belle Ln: E5,F4,F5
- Indian Trl: E4,E5,E6
- Interstate 24: H4,H5,I3,I4
- Interstate 75: A15,B14,B15,C14,D13,D14,E13
- Jason Dr: F5,F6
- Jennings Ln: A15
- John Arnold Ave: D11,D12
- John Ross Rd: A2,B2,B3,C3,C4,C5,D5
- John Sims Rd: G5
- Jordan Run: E17,F17
- Joshua Dr: A4
- Justine Ln: A3
- Kearill Ln: B9,C9
- Keblee St: A11,B11
- Keynton Dr: D7,D8
- Key West Ave: A10
- Kingwood Cir: C4,C5,D4
- Kingwood Dr: C4,C5,D4
- Koons Rd: A2
- L A Ln: B20,C20
- Land St: A1,A2
- Lanoir Cir: E7,E8
- Lanoir St: E7,E8,F8
- Lansdell Rd: B13,C13
- Laredo Ave: B3,C3,C4
- Laredo Ct: C4
- Larry Ln: G5
- Laurel Ln: I3
- Laurelwood Dr: A3,A4
- Lazard St: A8,A9,B6,B7,B8,C6
- Le Clercq Dr: F3
- Lee St: A7,B7
- Lenora Rd: B15
- Leslie Ave: D10
- Lisa Dr: E2
- Lockhart Ln: B10
- Louise Ave: F7,F8
- Lundy Ln: C7,C8
- Mack Smith Rd: A13,B13,B14,C14
- Madonna Ave: E8,E9
- Maiden Dr: C3
- Main St: I3
- Mana Ln: A5
- Maple Creek Ln: H4,H5
- Maple Ln: G5,H4,H5
- Maplewood Ln: B1,B2,C1
- Margaret Ln: A5
- Marietta St: A12,A13,B13
- Marion Ave: C9,C10,D9
- Marlboro Ave: D7,E7,F7,F8
- Marley Way: F5,F6
- Martha Ave: E17,E18,E19
- Mary Anna Dr: B2,B3
- Maryland Cir: E8
- Maryland Dr: D8,D9,E7,E8
- Mason Dr: G2,G3
- Mathews Dr: D9
- Maxwell Rd: A9,B9,B10,C10
- McBrien Rd: A7,B7,B8,C8,D8,D9,E9,E10
- McCall Rd: C13
- McDonald Rd: A14,B14
- McHann Dr: E5,F5
- McKinley St: A11
- Meadowlark Trl: B18,C18
- Melody Ln: B2,C2
- Melville Ave: F7
- Merida St: D10
- Merrill St: C6,D6
- Merrimac Cir: F4
- Michler Dr: E17,E18
- Milbro Cir: B3
- Mimbro Ln: E4,E5
- Mission Ridge Oval: I4
- Missionary Ave: A1,A2,A3
- Mocking Bird Dr: A19,B19
- Monroe St: C6,C7
- Moreview Rd: B17,B18,C17
- Moseley Cir: H3
- Mount Belvoir Dr: E5,F5,F6
- Myra Ave: E3
- Myrtle Ave: B6
- N Mack Smith Rd: D12
- N Mission Oaks Dr: A4,B4
- N Smith St: B13,C13
- Newport Dr: D7,D8,E7
- Norma Dr: G5,G6
- Northview Ave: G6
- Notre Dame Ave: E8,F8
- Nottingham Dr: D12
- O Dell St: A9,A10
- Oakdale Ave: B11,B12,C8,C9,C10,D8
- Old Ringgold Rd: D4,D5,E4,F2,F3,G2
- Olmead Dr: B3
- Orlando Ave: B4,B5,C5
- Parham Dr: E5,F5
- Patton Dr: A4,A5
- Patton Edwards Dr: A4,B4
- Peachtree Rd: B1
- Peck Dr: D11,D12
- Phelps St: B2,B3,C2,C3
- Pine Bluff Dr: A17,A18,B18
- Pine Top Ct: B18,C18
- Pinellas Ln: G4,G5
- Pioneer Ridge Trl: B6
- Pirtle St: G5
- Pleasant St: C10
- Pondexter Ave: F3,G3,G4
- Pontiac Dr: A7,B7
- Prater Rd: A12,B12
- Prigmore Dr: A8,A9,B9,C9
- Pyron Ln: E8
- Rebecca Dr: C8,C9
- Reeves Ave: C2,C3,D3
- Regiment Way: I3
- Reneau Way: E10
- Ridgefield Cir: A5,A6,B5,B6
- Ringgold Rd: A17,B10,B11,B12,B13,B14,B15,B16,B17,C7,C8,C9,C10,D4,D5,D6,D7,E3,E4,F2,F3,G2
- Roosevelt Rd: B8
- Roper St: A10,A11
- Rose St: A8,B8
- Rosebud Dr: C7,C8
- Rugby Pl: B1,B2,C1,C2
- S Crest Rd: A1
- S Germantown Rd: E4,F4,G4,G5,H5
- S Howell Ave: E10,F10
- S Lovell Ave: D8,D9,E9,F9
- S Mission Oaks Dr: A3,A4,B3,B4
- S Moore Rd: C8,D8,E8,E9,F9
- S Sanctuary Rd: A18,B18
- S Seminole Dr: B1,C1,C2,D2,E2,F2,G2,G3,H3,I3
- S Smith St: A13,B13
- S St Marks Ave: D9,E9,F9
- S Sweetbriar Ave: E7,F7,G7
- San Hsi Dr: B11,C11,C12
- Schmidt Rd: B6
- Schofield Ave: E12,C13
- Scott St: A10,A11
- Scruggs Rd: A17
- Sells Dr: D5,E5
- Seminole Crest Ln: F2
- Sewanee Dr: B11,C11
- Shadowlawn Dr: C2,D1,D2
- Shady Dr: E8
- Sharondale Rd: E8,F8
- Shelby Cir: D3
- Sheridan Ave: I3
- Sheridan Dr: H3,I3
- Sherlin Dr: A4,A5,B4
- Sherwood Dr: C12,D12
- Shirl Jo Ln: B2
- Slater Rd: B13,B14
- Small St: A13
- Spriggs St: B7,B8,B9
- Spring Creek Rd: B12,C12,D12,E11,E12
- Spring Valley Dr: D12
- Springvale Rd: A10,B10
- St James Ave: B12
- Myra Ave: E3
- St Thomas St: B15,C15,C16
- State Line Rd: A4,A5,A6,A7,A8,A10,A11,A12,A13,A14,A15
- Stimpson Dr: H4,H5
- Stone St: C8
- Straub Ave: A1
- Sullivan Ave: D4
- Summit Ave: F3,G3,H3
- Sunny Dell Cir: D10,E10
- Peck Dr: D11,D12
- Phelps St: B2,B3,C2,C3
- Pine Bluff Dr: A17,A18,B18
- Pine Top Ct: B18,C18
- Pinellas Ln: G4,G5
- Pioneer Ridge Trl: B6
- Pirtle St: G5
- Pleasant St: C10
- Pondexter Ave: F3,G3,G4
- Pontiac Dr: A7,B7
- Prater Rd: A12,B12
- Prigmore Dr: A8,A9,B9,C9
- Pyron Ln: E8
- Rebecca Dr: C8,C9
- Reeves Ave: C2,C3,D3
- Regiment Way: I3
- Reneau Way: E10
- Ridgefield Cir: A5,A6,B5,B6
- Ringgold Rd: A17,B10,B11,B12,B13,B14,B15,B16,B17,C7,C8,C9,C10,D4,D5,D6,D7,E3,E4,F2,F3,G2
- Roosevelt Rd: B8
- Roper St: A10,A11
- Rose St: A8,B8
- Rosebud Dr: C7,C8
- Rugby Pl: B1,B2,C1,C2
- S Crest Rd: A1
- S Germantown Rd: E4,F4,G4,G5,H5
- S Howell Ave: E10,F10
- S Lovell Ave: D8,D9,E9,F9
- S Mission Oaks Dr: A3,A4,B3,B4
- S Moore Rd: C8,D8,E8,E9,F9
- S Sanctuary Rd: A18,B18
- S Seminole Dr: B1,C1,C2,D2,E2,F2,G2,G3,H3,I3
- S Smith St: A13,B13
- S St Marks Ave: D9,E9,F9
- S Sweetbriar Ave: E7,F7,G7
- San Hsi Dr: B11,C11,C12
- Schmidt Rd: B6
- Schofield Ave: E12,C13
- Scott St: A10,A11
- Scruggs Rd: A17
- Sells Dr: D5,E5
- Seminole Crest Ln: F2
- Sewanee Dr: B11,C11
- Shadowlawn Dr: C2,D1,D2
- Shady Dr: E8
- Sharondale Rd: E8,F8
- Shelby Cir: D3
- Sheridan Ave: I3
- Sheridan Dr: H3,I3
- Sherlin Dr: A4,A5,B4
- Sherwood Dr: C12,D12
- Shirl Jo Ln: B2
- Slater Rd: B13,B14
- Small St: A13
- Spriggs St: B7,B8,B9
- Spring Creek Rd: B12,C12,D12,E11,E12
- Spring Valley Dr: D12
- Springvale Rd: A10,B10
- St James Ave: B12
- Tanager Ct: B17,B18
- Ten Oaks Dr: C1,C2
- Tiffany Ln: C17,C18,D17
- Tom Wilson Trl: H3
- Tombras Ave: A7,B7,C7
- Truman Ave: A12,B12
- Vester Ln: B7,B8
- Village Lake Cir: B16,B17
- W End Ave: C9,C10
- W Stump St: A4,A5
- Wade Dr: F6,F7
- Wahela Rd: B1
- Wake Robin Dr: C17,C18
- Wakulla Dr: E2
- Wando Dr: F8
- Waterhouse St: A11,B11
- Weaver St: D9,D10,E9
- Weldon Dr: D4,D5,E4
- Welworth Ave: C11,C12
- Wentworth Ave: C11,C12,D11
- Westonia Dr: H3,H4
- Whitehead Ave: D3,D4
- Wiley Ave: F7,G6,G7
- Wimberly Ln: D4,D5,E4,E5
- Wonder Dr: C5
- Woodard Cir: B10
- Woodmont Dr: D5,D6
- Worsham Ave: F8
- Wren Rd: A5
- Wright St: B15,C15
- Wynwood Rd: E2,F2,F3
- Yale St: C11,D11

December 21, 2017



- Streets
- Open Private
- Open Public
- State Route
- Parcel Boundaries
- Redevelopment plan study area

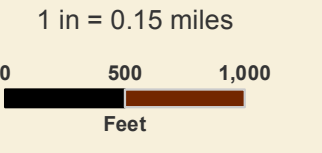

TENNESSEE GEORGIA